

Control Cable Knob Installation

Eligibility: Beechcraft Bonanza Models J35, K35, M35, N35, P35, S35, V35, V35TC, V35A, V35A-TC, V35B, V35B-TC, 33, A33, B33, C33, C33A, E33, E33A, F33, F33A, F33C, G33, 36, A36, A36TC, B36TC.

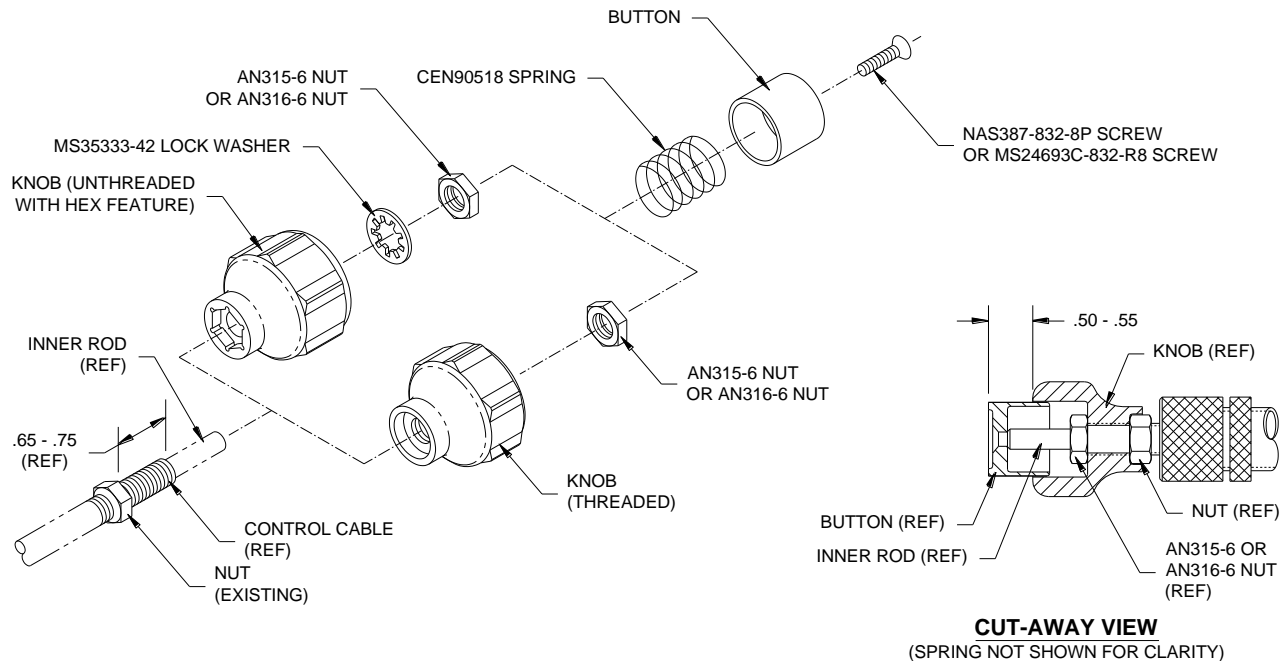

Figure 1. Control Cable Knob Installation

Control Cable Knob Installation Instructions (see Figure 1.):

1. For control cables with floating nut - Adjust the existing nut so that the distance from the top of the nut to the threaded end of the control cable is approximately .65 inch (.75 inch if installing knob with recessed hex feature).
2. Thread knob onto control cable until it bottoms out on the existing nut.
(For knobs without internal threads, position the knob so that the recessed hexagonal feature on the knob fits over the nut on the control cable.)
3. Install AN315-6 or AN316-6 jam nut and tighten both existing nut & jam nut against knob.
(For knobs without internal threads, install MS35333-42 lock washer as shown.) Torque nuts to 110±10 in-lbs.

CAUTION

Knob must be properly installed (see Steps 1 – 3) prior to installing spring and button. If the button bottoms out on the knob while the screw is being tightened, there will be enough force exerted on the inner rod to damage the control cable assembly.

4. Install the spring and button, securing the button with the countersunk screw. Verify that the button protrudes no more than .55 inch from the knob. Otherwise, adjust the existing nut, knob, & AN315-6 or AN316-6 nut as required. Torque screw to 40±5 in-lbs. Do not tighten the screw with the button pressed in.

5. Check the control cable assembly for smoothness and proper travel by pulling and pushing on the knob with the button pressed in. With the button released, the cable should not move. Also verify that the knob cannot be rotated on the control cable shaft.

WARNING

Inadequately torqued nuts can lead to the loosening of the control knob resulting in improper operation of vernier control.

6. Questions or comments? Please contact:
Centex Aerospace Inc.
Tel. No. 254-752-4290
www.centex.aero